

the westin crown center

the westin crown center
one east pershing road kansas city, missouri 64108
t 816.474.4400 f 816.391.4438
westin.com/crowncenter



Kansas City offers visitors a distinctive travel experience and an inspired hotel in the very heart of the city. Conveniently situated within Hallmark Crown Center, with its more than 85 acres of shops, restaurants, live theaters, and a salon/spa the Westin Crown Center is just 10 blocks from the downtown KC Power and Light Entertainment District, Sprint Center arena, College Basketball Experience interactive "museum" and Bartle Hall/KC Convention Center. The Westin is also located minutes from the renowned Country Club Plaza. Just next door is Liberty Memorial, the country's only WWI Museum. The Link, a climate controlled glass sky bridge, leads directly to Union Station with prominent traveling art exhibits and the popular Science City.

guest accommodations

Each of our 724 guestrooms offer the Heavenly Bed, Heavenly Bath, high-speed Internet access, refrigerator, safe, in-room movies and 37-inch LCD televisions. Additional accommodations include 27 spacious suites, such as the opulent 1,350-square foot Presidential and State Suite, which each feature a dining room, large living room with fireplace and Bose stereo system.

dining

Enjoy elegant Benton's Prime Steakhouse, serving Kansas City's best dry aged steaks and fresh seafood. The restaurant's rooftop setting provides breathtaking views of the Kansas City skyline. Listen to live jazz weekend evenings.

Brasserie offers sophisticated ambience and Continental cuisine for breakfast, lunch and dinner.

The hotel also offers 24-hour in-room dining.

meetings & social affairs

A total of 30 meeting rooms are offered, with 53,873 square feet of meeting space—32,000 square feet of which are located exclusively on the ballroom level. The largest space measures 16,089 square feet and hosts up to 2,000 attendees. Six deluxe conference rooms are also available on the fifth floor.

The hotel connects to the Crown Center Exhibition Hall via The Link, where an additional 40,500 square feet of exhibit space are available (5,000 square feet of pre-function space). Special features include same-level loading docks, 20-foot ceiling clearance, indoor access, on-site covered parking, polished concrete floors, and capacity for 284 eight-foot by ten-foot booths.

recreation & attractions

Our huge WestinWORKOUT® fitness center features free weights, weight machines, a separate cardio theater with two dozen machines, sauna, steam, tennis courts, tanning, an outdoor heated pool open year-round, an indoor whirlpool and locker rooms.



floor plans & capacity chart

LOBBY LEVEL

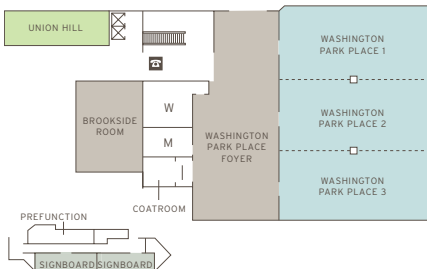

EXECUTIVE OFFICE LEVEL

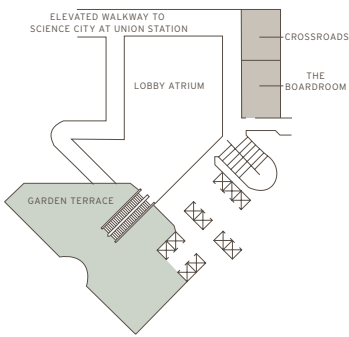

BALLROOM LEVEL

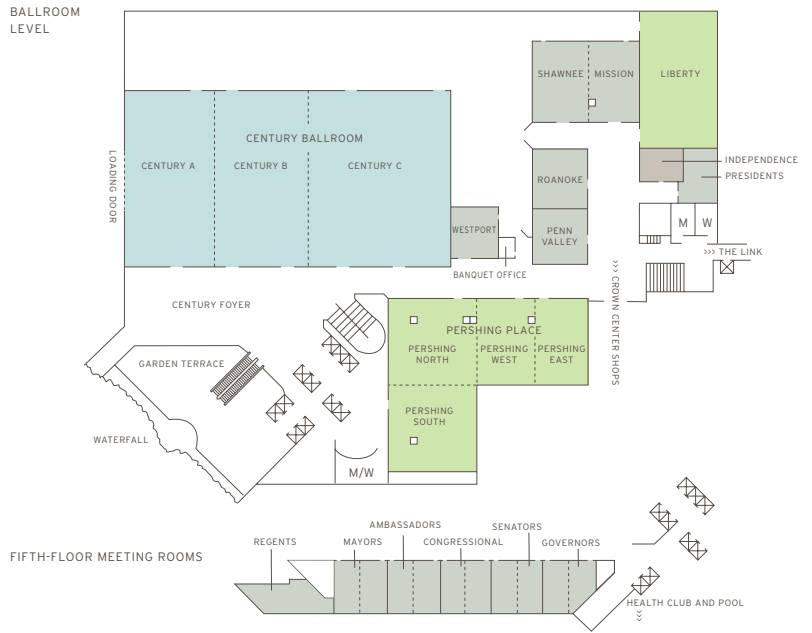

FIFTH-FLOOR MEETING ROOMS

ROOM NAME	TOTAL SQ. FEET	DIMENSIONS	CEILING	THEATER	SCHOOLROOM	CONFERENCE	U-SHAPE	HOLLOW SQUARE	RECEPTION	ROUNDS OF 10	8 x 10/ 10 x 10 BOOTHS
BALLROOM LEVEL											
CENTURY BALLROOM	16,089	93' x 173'	18'	2,000	966	-	-	-	2,000	1,180	85/73
CENTURY A & B	8,742	94' x 93'	18'	1,100	546	-	-	-	1,100	600	42/37
CENTURY B & C	11,439	93' x 123'	18'	1,460	672	-	-	-	1,400	770	55/48
CENTURY A	4,650	50' x 93'	18'	540	252	-	80	-	500	320	24/19
CENTURY B	3,999	43' x 93'	18'	450	220	-	70	-	400	300	18/15
CENTURY C	7,347	79' x 93'	18'	875	420	-	125	-	750	560	37/30
CENTURY FOYER	4,400	40' x 110'	18'	-	-	-	-	-	400	-	-/-
PERSHING PLACE	6,777	-	-	-	-	-	-	-	675	410	37/18
PERSHING EAST	1,118	26' x 43'	12'	100	60	35	35	40	120	100	7/4
PERSHING WEST	1,333	31' x 43'	12'	100	60	35	35	40	120	100	7/4
PERSHING NORTH	1,760	40' x 44'	12'	110	80	35	35	40	180	140	10/5
PERSHING SOUTH	1,763	41' x 43'	9'	110	80	35	35	40	180	140	9/5
LIBERTY ROOM	3,010	43' x 70'	12'	325	190	60	55	60	375	200	17/13
SHAWNEE AND MISSION ROOM	2,451	43' x 57'	12'	250	120	50	50	190	275	190	14/-
SHAWNEE ROOM	1,118	26' x 43'	12'	100	60	38	35	90	120	90	8/-
MISSION ROOM	1,333	31' x 43'	12'	110	80	38	35	100	130	100	8/-
ROANOKE ROOM	980	28' x 35'	12'	90	60	34	30	80	100	80	-/-
PENN VALLEY ROOM	616	22' x 28'	12'	60	40	22	24	60	70	60	-/-
WESTPORT ROOM	600	24' x 25'	12'	50	36	22	18	40	60	40	-/-
PRESIDENTS ROOM	540	20' x 27'	12'	50	30	22	18	40	60	40	-/-
INDEPENDENCE ROOM	399	19' x 21'	12'	30	20	16	15	30	35	30	-/-
LOBBY LEVEL											
WASHINGTON PARK PLACE	4,988	86' x 58'	12'	480	280	-	-	-	500	340	29/-
WASHINGTON PARK PLACE 1	1,856	32' x 58'	12'	176	90	40	45	54	200	150	9/-
WASHINGTON PARK PLACE 2	1,624	28' x 58'	12'	165	93	40	44	52	180	140	9/-
WASHINGTON PARK PLACE 3	1,508	26' x 58'	12'	143	72	40	42	48	140	100	9/-
WASHINGTON PARK PLACE FOYER	2,650	84' x 38'	-	-	-	-	-	-	300	-	-/-
BROOKSIDE ROOM	1,064	28' x 33'	9'	110	51	30	35	40	110	70	-/-
UNION HILL	688	16' x 43'	9'	35	20	20	30	36	40	30	-/-
SIGNBOARD I	783	20' x 38'6"	9'	50	33	25	25	30	50	40	-/-
SIGNBOARD II	625	20' x 30'6"	9'	40	30	24	20	24	40	30	-/-
EXECUTIVE OFFICE LEVEL											
THE BOARDROOM	651	21' x 31'	8'	-	-	12	-	-	-	-	-/-
GARDEN TERRACE	3,657	62' x 113'	-	-	-	-	-	-	275	200	-/-
CROSSROADS	638	29' x 22'	8'	45	27	24	20	24	45	30	-/-
FIFTH-FLOOR LEVEL											
BOARDROOMS (6)	514	27' x 19'	8'	40	22	21	24	-	40	30	-/-
CROWN CENTER											
EXHIBIT HALL AB	45,500	-	-	-	-	-	-	-	-	3,000	284/247
EXHIBIT HALL A	30,500	179' x 157'	20'	-	-	-	-	-	2,100	1,900	204/160
EXHIBIT HALL B	15,000	182' x 82'	20'	1,800	900	-	-	-	1,800	1,100	89/77

*Note: Above capacities are maximums with no allowance for audio visual or other items